

Low V_F Schottky Barrier Diode

Feature

- Forward Current: 4A
- Reverse Voltage: 40V
- Low Forward Voltage
- Low Leakage Current
- Trench MOS Barrier Schottky Technology

Applications

- Low Current Rectification
- Voltage Clamping
- Protection Circuits
- Ultra High-speed Switching

Mechanical Characteristics

- Lead finish: 100% matte Sn(Tin)
- Mounting position: Any
- Qualified max reflow temperature: 260°C
- Pure tin plating: 7 ~ 17 μm

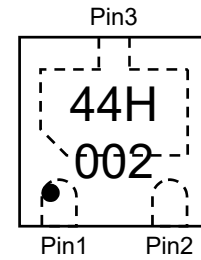

Marking (Top View)

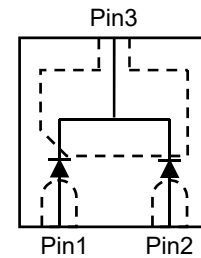

Circuit Diagram

Electrical characteristics per line@25°C (unless otherwise specified)

Parameter	Symbol	Conditions	Min.	Typ.	Max.	Units
Forward Voltage	V_F	$I_F = 2\text{A}$, Pin1/Pin2 to Pin 3	-	0.47	0.6	V
		$I_F = 4\text{A}$, Pin1&Pin2 to Pin3	-	0.47	0.6	
Reverse Current	I_R	$V_R = 40\text{V}$, Pin3 to Pin1/Pin2	-	-	10	μA
Breakdown Voltage	V_{BR}	$I_t = 1\text{mA}$, Pin3 to Pin1/Pin2	41	-	-	V
Junction Capacitance	C_J	$V_R = 0\text{V}$, $f = 1\text{MHz}$, Pin3 to Pin1/Pin2	-	450	-	pF
Reverse Recovery Time	T_{rr}	Pin1/Pin2 to Pin 3	-	50	-	nS

Absolute maximum rating@25°C

Rating		Symbol	Value	Units
Reverse Voltage (DC)		V_{RWM}	40	V
Average Forward Rectified Current	Pin1/Pin2 to Pin 3	I_F	2.0	A
	Pin1&Pin2 to Pin3		4.0	
Peak Forward Surge Current(8.3ms Single Half Sine-wave Superimposed on Rated Load)(Pin1/Pin2 to Pin 3)		I_{FSM}	25	A
Junction and Storage Temperature Range		T_J, T_{STG}	-55~+150	°C
ESD Protection-Contact Discharge		V_{ESD}	± 30	kV
ESD Protection-Air Discharge		V_{ESD}	± 30	kV

Typical Characteristics

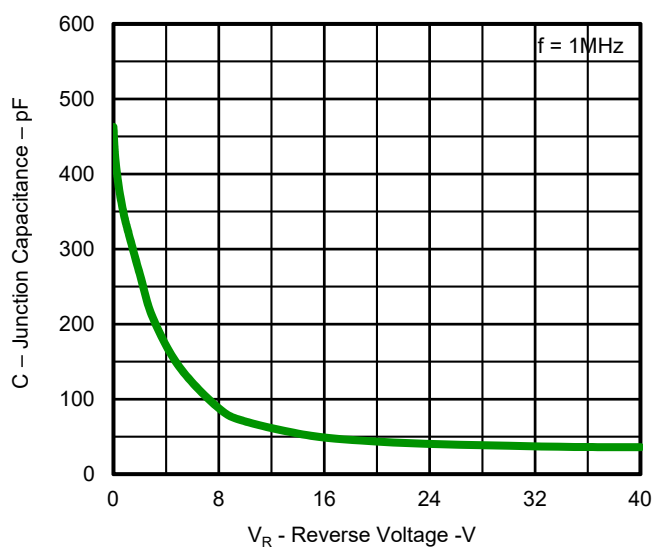
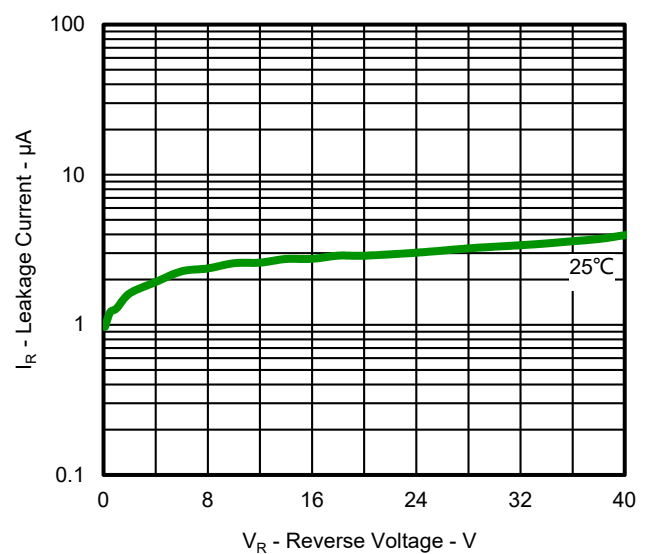
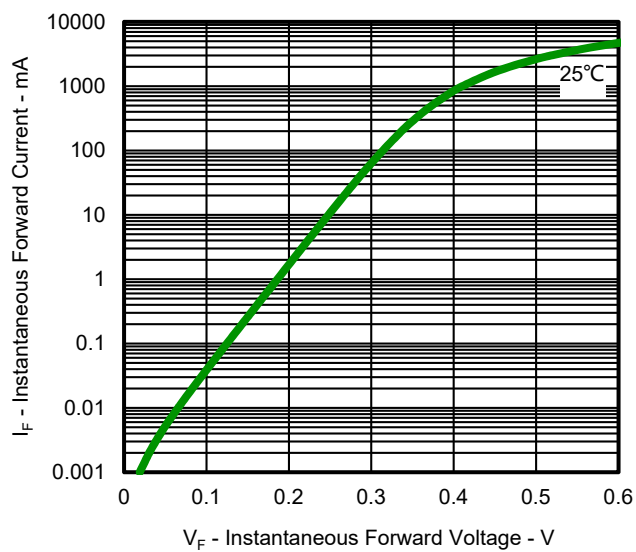

Solder Reflow Recommendation

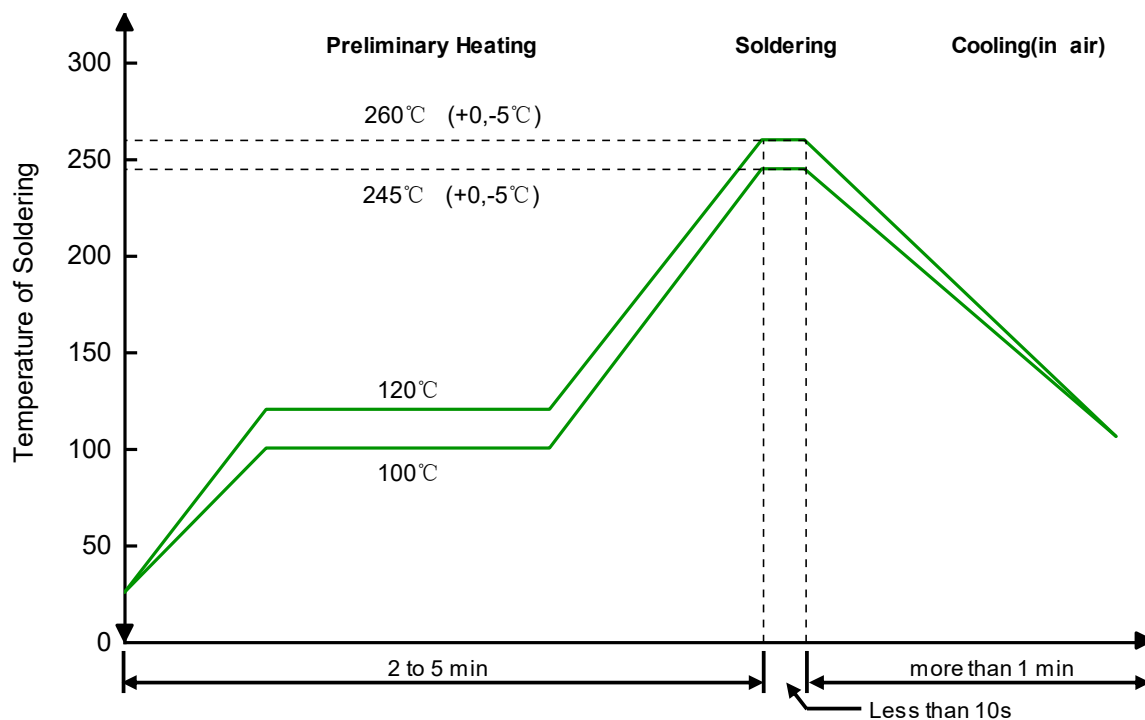

Remark: Pb free for 260°C; Pb for 245°C.

Ordering information

Package	Reel	Shipping
DFN2020-3L	7"	3000 / Tape & Reel

Load with information

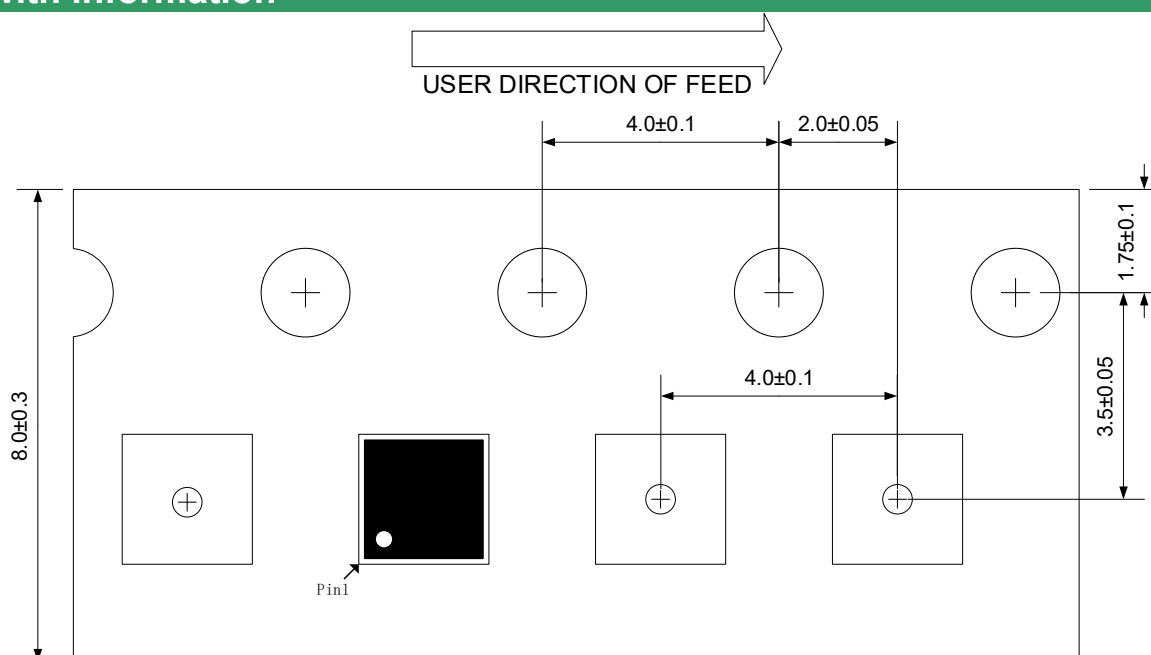

Unit:mm

Product Dimension (DFN2020-3L)

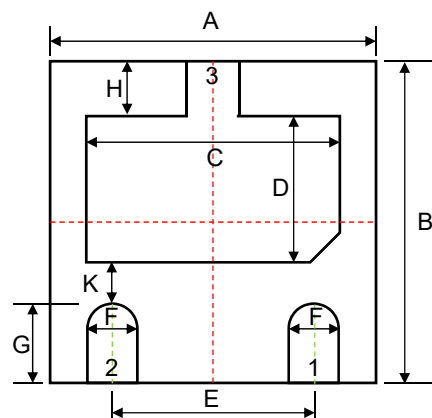

Bottom View

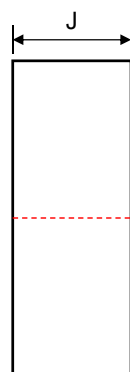

Side View

Dim	Millimeters		Inches	
	Min	Max	Min	Max
A	1.90	2.10	0.075	0.083
B	1.90	2.10	0.075	0.083
C	1.40	1.60	0.055	0.063
D	0.90	1.15	0.035	0.045
E	1.30 BSC		0.051 BSC	
F	0.25	0.35	0.010	0.014
G	0.35	0.45	0.014	0.018
H	0.15	0.30	0.006	0.012
J	0.50	0.60	0.020	0.024
K	0.30 BSC		0.012 BSC	

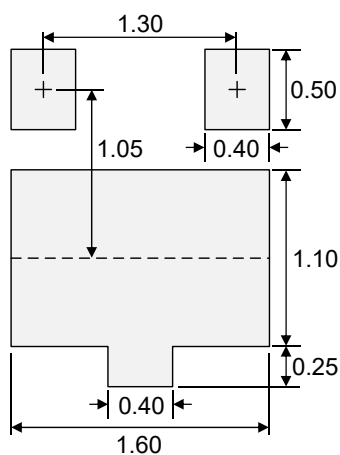

Suggested PCB Layout

Unit: mm

IMPORTANT NOTICE

 and **Prisemi**[®] are registered trademarks of **Prisemi Electronics Co., Ltd** (Prisemi), Prisemi reserves the right to make changes without further notice to any products herein. Prisemi makes no warranty, representation or guarantee regarding the suitability of its products for any particular purpose, nor does Prisemi assume any liability arising out of the application or use of any product or circuit, and specifically disclaims any and all liability, including without limitation special, consequential or incidental damages. "Typical" parameters which may be provided in Prisemi data sheets and/or specifications can and do vary in different applications and actual performance may vary over time. All operating parameters, including "Typicals" must be validated for each customer application by customer's technical experts. Prisemi does not convey any license under its patent rights nor the rights of others. The products listed in this document are designed to be used with ordinary electronic equipment or devices, Should you intend to use these products with equipment or devices which require an extremely high level of reliability and the malfunction of with would directly endanger human life (such as medical instruments, aerospace machinery, nuclear-reactor controllers, fuel controllers and other safety devices), please be sure to consult with our sales representative in advance.

Website: <http://www.prisemi.com>

For additional information, please contact your local Sales Representative.

©Copyright 2009, Prisemi Electronics

 **Prisemi**[®] is a registered trademark of Prisemi Electronics.

All rights are reserved.