

1.5A SURFACE MOUNT GLASS PASSIVATED BRIDGE RECTIFIER
Feature

- Glass Passivated Chip Junction
- Reverse Voltage - 100 to 1000 V
- Forward Current – 1.5A
- High Surge Current Capability
- Designed for Surface Mount Application

Maximum Ratings and Electrical characteristics

Ratings at 25 °C ambient temperature unless otherwise specified.

Single phase half-wave 60 Hz, resistive or inductive load, for capacitive load current derate by 20%.

| Parameter | Symbol | TB1 S-15 | TB2 S-15 | TB4 S-15 | TB6 S-15 | TB8 S-15 | TB10 S-15 | Units |
|--|-------------------|-------------|-------------|-------------|-------------|-------------|--------------|---------------|
| Maximum Repetitive Peak Reverse Voltage | V_{RRM} | 100 | 200 | 400 | 600 | 800 | 1000 | V |
| Maximum RMS Voltage | V_{RMS} | 70 | 140 | 280 | 420 | 560 | 700 | V |
| Maximum DC Blocking Voltage | V_{DC} | 100 | 200 | 400 | 600 | 800 | 1000 | V |
| Average Rectified Output Current at $T_a = 40\text{ °C}$ | I_o | 1.5 | | | | | | A |
| Peak Forward Surge Current 8.3ms Single Half Sine Wave Superimposed on Rated Load(JEDEC Method) | I_{FSM} | 50 | | | | | | A |
| | Typical I_{FSM} | 55 | | | | | | |
| Maximum Forward Voltage at 1.5A | V_F | 1.1 | | | | | | V |
| Maximum DC Reverse Current at Rated DC Blocking Voltage $T_a=25\text{ °C}$ $T_a=125\text{ °C}$ | I_R | 5.0 | | | | | | μA |
| | | 100 | | | | | | |
| Typical Junction Capacitance (Note1) | C_j | 13 | | | | | | PF |
| Typical Thermal Resistance (Note2) | $R_{\theta JA}$ | 160 | | | | | | °C/W |
| | $R_{\theta JL}$ | 25 | | | | | | |
| Operating and Storage Temperature Range | T_J, T_{STG} | -55 to +150 | | | | | | °C |

Note:

1. Measured at 1MHz and applied reverse voltage of 4 V D.C.
2. Mounted on glass epoxy PC board with 1.3mm² copper pad.

1.5A SURFACE MOUNT GLASS PASSIVATED BRIDGE RECTIFIER

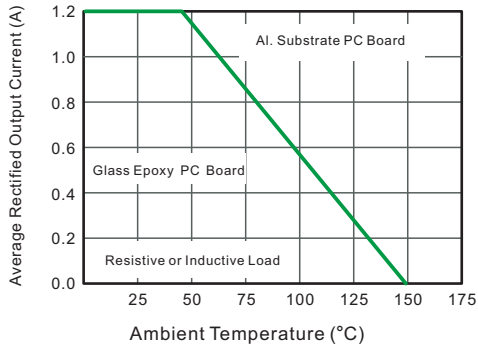

Fig.1 Average Rectified Output Current Derating Curve

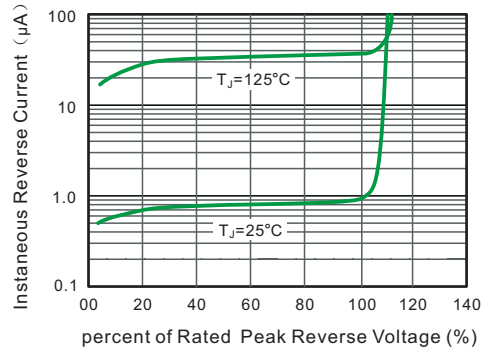

Fig.2 Typical Reverse Characteristics

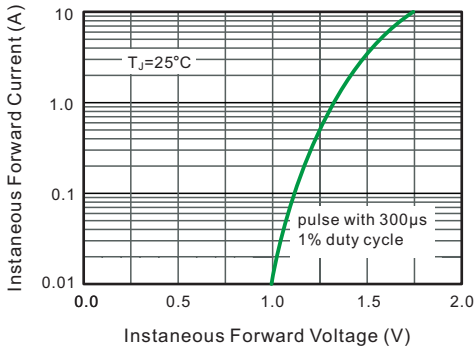

Fig.3 Typical Instantaneous Forward Characteristics

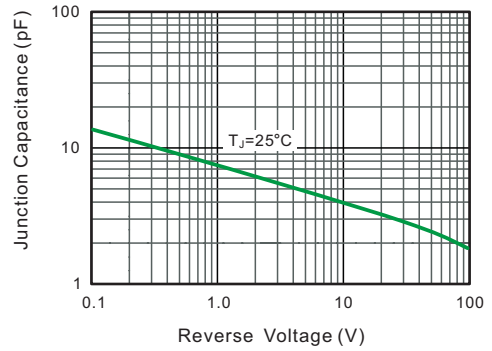

Fig.4 Typical Junction Capacitance

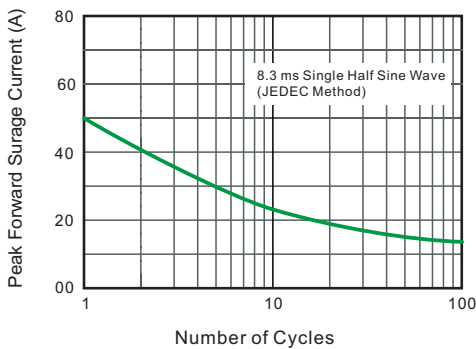
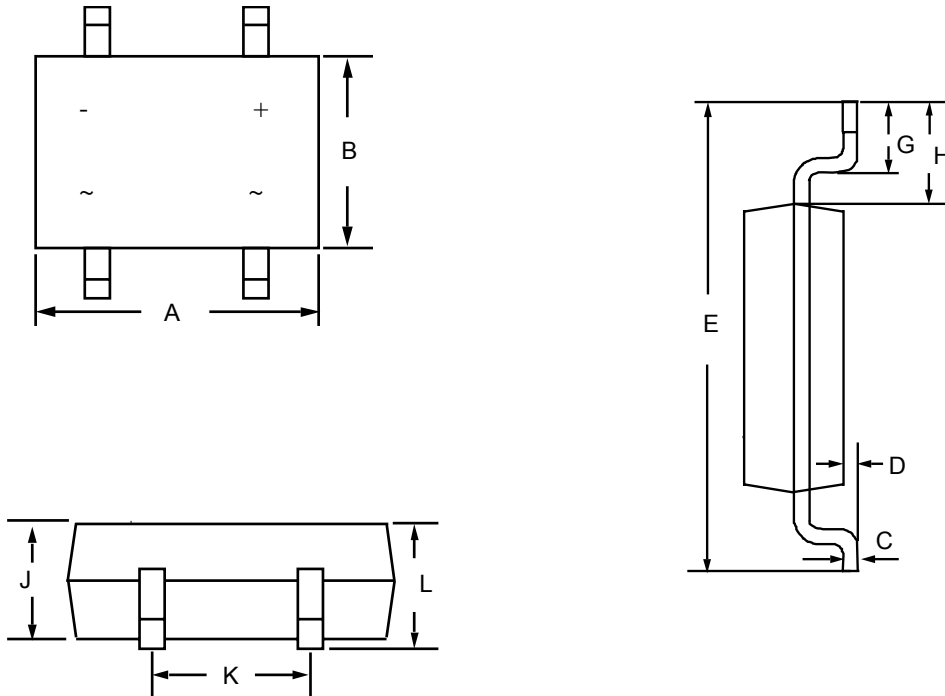

Fig.5 Maximum Non-Repetitive Peak Forward Surge Current

1.5A SURFACE MOUNT GLASS PASSIVATED BRIDGE RECTIFIER

Product dimension (ABS)



| Dimension | Millimeters | |
|-----------|-------------|------|
| | MIN | MAX |
| A | 4.90 | 5.30 |
| B | 4.30 | 4.80 |
| C | 0.15 | 0.25 |
| D | 0.05 | 0.15 |
| E | 6.00 | 6.40 |
| G | 0.30 | 0.80 |
| H | 0.80 | 1.20 |
| J | 1.20 | 1.40 |
| K | 3.80 | 4.20 |
| L | -- | 1.50 |

Ordering information

| Device | Package | Shipping |
|------------------|---------------|--------------------|
| TB1S-15~TB10S-15 | ABS (Pb-Free) | 5000 / Tape & Reel |

1.5A SURFACE MOUNT GLASS PASSIVATED BRIDGE RECTIFIER

IMPORTANT NOTICE

 and **Prisemi**[®] are registered trademarks of **Prisemi Electronics Co., Ltd (Prisemi)** ,Prisemi reserves the right to make changes without further notice to any products herein. Prisemi makes no warranty, representation or guarantee regarding the suitability of its products for any particular purpose, nor does Prisemi assume any liability arising out of the application or use of any product or circuit, and specifically disclaims any and all liability, including without limitation special, consequential or incidental damages. “Typical” parameters which may be provided in Prisemi data sheets and/or specifications can and do vary in different applications and actual performance may vary over time. All operating parameters, including “Typicals” must be validated for each customer application by customer’s technical experts. Prisemi does not convey any license under its patent rights nor the rights of others. The products listed in this document are designed to be used with ordinary electronic equipment or devices, Should you intend to use these products with equipment or devices which require an extremely high level of reliability and the malfunction of with would directly endanger human life (such as medical instruments, aerospace machinery, nuclear-reactor controllers, fuel controllers and other safety devices), please be sure to consult with our sales representative in advance.

Website: <http://www.prisemi.com>

For additional information, please contact your local Sales Representative.

©Copyright 2009, Prisemi Electronics

 **Prisemi**[®] is a registered trademark of Prisemi Electronics.

All rights are reserved.